

Sliding Anchor Systems

A range of heavy duty (welded) and light duty (bent and/or twisted) stems. Available in standard stem lengths, head sizes and hole configurations with other options available on request. This range of products secure cavity walls to overhead structures, whilst accommodating vertical movement. Used in conjunction with one or two way sliding ties (ordered separately).

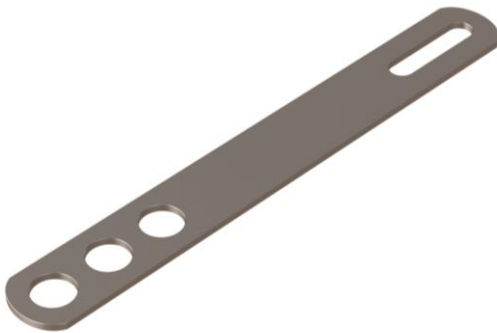

Product

SOW Sliding One Way Tie

SOW is designed to be used with Vista sliding anchor systems and allow the ties to move up and down in the stem. Ties are supplied with a 3-holed safety end for bonding into the mortar. The ties can slot to slide up or down the stem.

Sizes: 115mm

135mm

Plus special sizes to order

Safety Precautions

SOW Sliding One Way Ties are manufactured from sheared plate and strip and may contain sharp edges. Suitable personal protection should always be used when handling/installing these products.

Head Office: Vista Engineering Ltd, Carr Brook Works, Elnor Lane, Whaley Bridge, High Peak SK23 7JN
Tel: Sales: +44 (0) 1663 736 700 Fax: +44 (0) 1663 736 710

Scotland Office: Vista Engineering Ltd, 79 Dunn Street, Parkhead, Glasgow, G40 3PA
Tel: +44 (0) 141 613 3144 Fax: +44 (0) 141 613 3031

web: www.vistaeng.co.uk email: sales@vistaeng.co.uk